

# Reel Holder

Part No. 8930201

## Instructions for use

### Contents of delivery

- 1 - Base (with thread holes in the middle)
- 2 - Base (with holes in the middle)
- 3 - Connecting piece
- 4 - Washer
- 5 - Axle shaft
- 6 - 4 Feet with thread pin M6x10  
(installed in bas 1,2)
- 7 - 3 Countersunk screws - phillips M4x8
- 8 - 2 Cylinder screws with hexagonal M6x30
- 9 - Countersunk screw with hexagonal M8x18
- 10 - 2 Washers Ø6.4
- 11 - 5 mm hex wrench

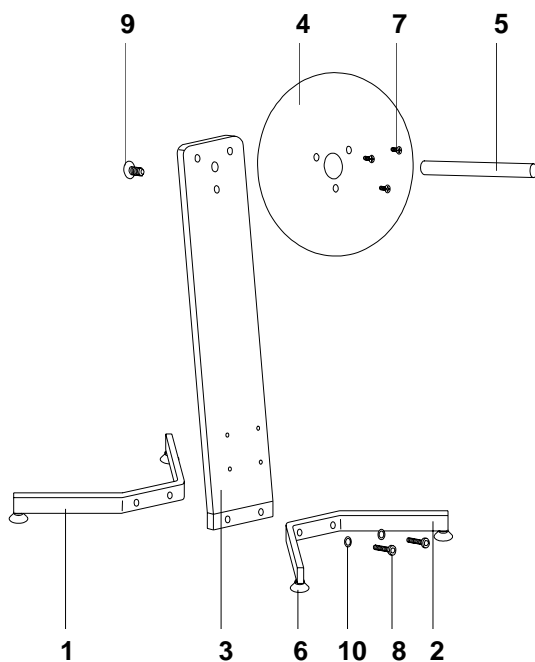

### Setting up

1. Fasten the base (2) and the connecting piece (3) with the cylinder screws (8) on the base (1). (put on the washer (10) on the cylinder screws), insert the connecting piece so that it bend backwards (opposite the screw head), the 4 feet (6) must show down.
2. Put the washer (4) on the connecting piece (3) with the 3 countersunk screws (7), the drill holes in the washer are lowered on one side.
3. Fasten the axle shaft (5) and the connecting piece (3) with the countersunk screws (7). Put the countersunk screws from behind the connecting piece and screw on the axle shaft.
4. To ensure the best standing position adjust the 4 feet (6).