

Operator's Manual

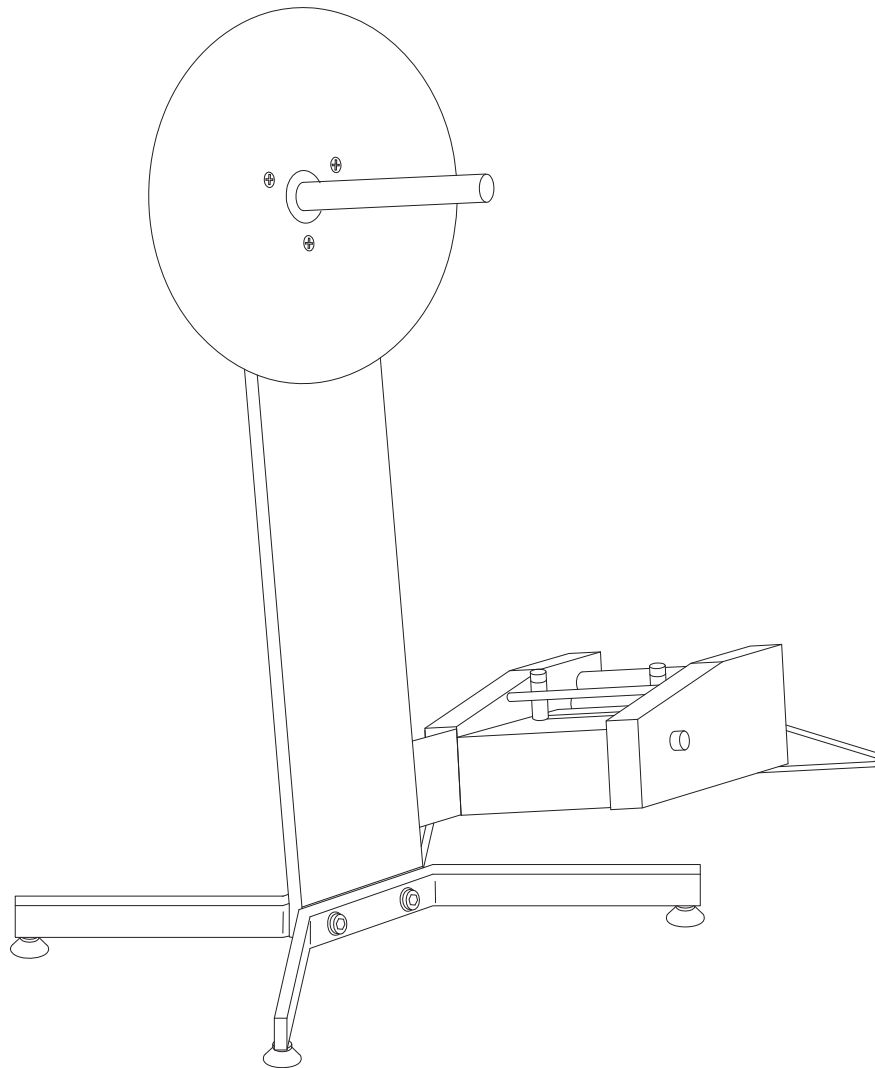

Unwinder

Edition: 01/2016 - Part No. 9008122

Copyright

This documentation as well as translation hereof are property of cab Produkttechnik GmbH & Co. KG.
The replication, conversion, duplication or divulgement of the whole manual or parts of it for other intentions than its original intended purpose demand the previous written authorization by cab.

Editor

Regarding questions or comments please contact cab Produkttechnik GmbH & Co. KG.

Topicality

Due to the constant further development of our products discrepancies between documentation and product can occur. Please check www.cab.de for the latest update.

Terms and conditions

Deliveries and performances are effected under the General conditions of sale of cab.

Table of Contents

1	Product Description.....	3
2	Safety Precautions.....	3
3	Contents of Delivery	3
4	Setting Up	4
5	Loading Material.....	4
6	Operation	5
7	Maintenance	5
8	EU Declaration of Conformity	6

Germany

cab Produkttechnik
GmbH & Co KG
Postfach 1904
D-76007 Karlsruhe
Wilhelm-Schickard-Str. 14
D-76131 Karlsruhe
Phone +49 721 6626-0
Fax +49 721 6626-129
www.cab.de
info@cab.de

France

cab technologies s.a.r.l.
F-67350 Niedermodern
Phone +33 388 722 501
www.cab.de/fr
info.fr@cab.de

USA

cab Technology Inc.
Tyngsboro MA, 01879
Phone +1 978 649 0293
www.cab.de/us
info.us@cab.de

Asia 亚洲

cab Technology Co., Ltd.
希愛比科技股份有限公司
Junghe, Taipei, Taiwan
Phone +886 2 8227 3966
www.cab.de/tw
info.asia@cab.de

China 中国

cab (Shanghai) Trading Co., Ltd.
鈺博(上海)貿易有限公司
Phone +86 21 6236-3161
www.cab.de/cn
info.cn@cab.de

Further partners on request

1 Product Description

The Unwinder is an attachment for the Universal Cutter FS 100. The unwinder pulls round and flat cables from the spool and feeds into the FS 100. Thereby any variation in the length of the material will be minimized.

The unwinder is used with the Reel Holder, which is also an option for FS 100.

Technical Data

(valid for the system Reel Holder - Unwinder)

Dimension (LxWxH)	570 mm x 360 mm x 570 mm
Weight	7,5 kg
Reel diameter	max. 640 mm
Reel with	max. 170 mm
Material width	max. 100 mm
Material thickness	max. 8 mm
Reel weight	max. 30 kg
Electrical connection	24 V=, 1 A, connection via FS 100
Feed rate	max. 300 mm/s
Part No. Unwinder	8930202
Part No. Reel Holder	8930201

2 Safety Precautions



Attention!

- ▶ Do not use the machine for any other purpose than it's intended use.
- ▶ Place the machine on a firm surface
- ▶ Turn on the FS 100 and the unwinder in correct order ▷ Section 6.



Warning!

The transport rollers of the unwinder are accessible,

- ▶ Ensure that all loose hanging items jewelry, hair, clothing are kept away from the rollers.

3 Contents of Delivery

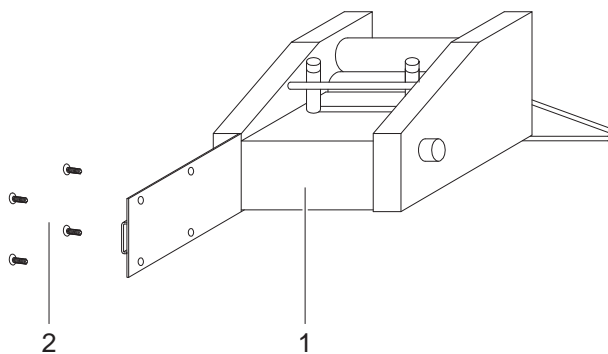

- 1 Unwinder
- 2 4 screws M4x10 with washers and spring rings

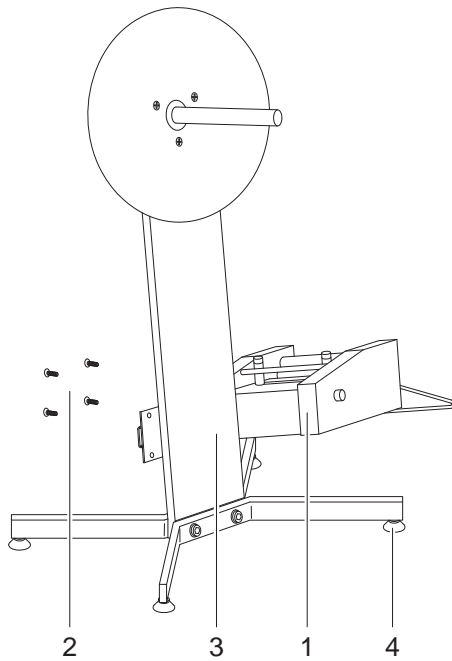

1. Connect the uninder (1) from behind with the 4 screws (2, incl. washers) to the reel holder.
2. Adjust the four feet (4) of the reel holder to ensure the standing position.
3. Make sure that the distance between the uninder and the FS 100 is about 400 mm.
4. Turn off FS 100.
5. Connect the uninder's power cable at the connection socket of the FS 100.

5 Loading Material

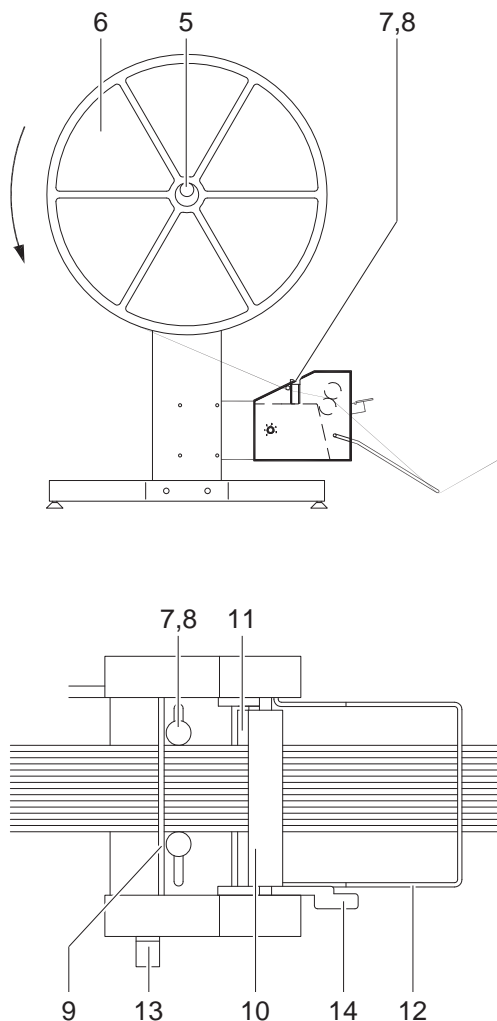

1. Put the reel (6) on to the shaft (5) so that the spool rotates counterclockwise.
2. Loose the screws (8) and push the rollers (7) apart.
3. Move the material under the axle (9) to the transport rollers (10,11), press the handle (14) to move the transport roller (11) down, move the material between the rollers.
4. Move the material under the feeler (12) to the FS 100.
5. Adjust the rollers (7) so that the material easily moves, tighten the screws.
6. Tighten the screws (8).
7. Adjust the uninder so that the material moves easily and without stress into the FS 100.

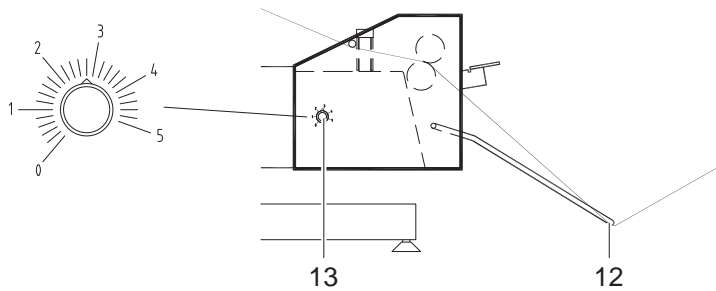

The unwinder is controlled through the position of the feeler (12).

The machine transports the material, when the material under the feeler is pushed forward and tightened up and the feeler lifts up. When the material loosens up the feeler lifts down and stops the transport of the material.

The unwinder gets its power supply through the FS 100.



Warning!

The transport rollers of the unwinder are accessible,

▶ **Ensure that all loose hanging items jewelry, hair, clothing are kept away from the rollers.**

- ▶ Before turning on the FS 100 please bring the regulator (13) of the unwinder in position "0". In this position the motor is turned off.
- ▶ Turn on the FS 100.
- ▶ Before starting the cutting process, please bring the regulator in a position between "0.2" and ">5". This controls the turn on-off frequency of the unwinder :
 - Between the lift up of the feeler (12) and the start of the unwinder is a delay. This is in position "5" very small, nearly to position "0" the delay is about 3 seconds.
 - The unwinder reaches its maximum feed speed in position "5" just after start. Nearly to "0" the unwinder reaches the maximum speed 5 seconds after the start.
- ▶ In use of a big reel and the maximum speed at the FS 100 bring the regulator in position "5".
- ▶ In use of a smaller load turn the regulator down, so that the machine runs smooth.



Notice!

- ▶ **Make sure that there is always material under the feeler and the material is not tightened up.**

7 Maintenance

- ▶ When required clean the transport rollers with spirit and a dust free cloth.



EU Declaration of Conformity

We declare herewith that the following device as a result of design, construction and the version put in circulation complies with the relevant fundamental regulations of the EU Rules for Safety and Health. In the event of any alteration which has not been approved by us being made to any device as designated below, this statement shall thereby be made invalid.

Device:	Unwinder
Applied EU Regulations and Norms:	
Directive 2006/42/EC on machinery	<ul style="list-style-type: none"> • EN ISO 12100:2010 • EN ISO 13857:2008 • EN 349:1993+A1:2008 • EN ISO 13849-1:2008 • EN 61029-1:2009+A11:2010 • EN 61558-1:2005+A1:2009
Directive 2014/30/EU relating to electromagnetic compatibility	<ul style="list-style-type: none"> • EN 61000-3-2:2006+A1:2009+A2:2009 • EN 61000-3-3:2008 • EN 61000-6-2:2005 • EN 61000-6-3:2007+A1:2011
Directive 2011/65/EU on the restriction of the use of certain hazardous substances in electrical and electronic equipment	<ul style="list-style-type: none"> • EN 50581:2012
Person authorised to compile the technical file :	Erwin Fascher Am Unterwege 18/20 99610 Sömmerda
Signed for, and on behalf of the Manufacturer :	Sömmerda, 18.01.2016
cab Produkttechnik Sömmerda Gesellschaft für Computer- und Automationsbausteine mbH 99610 Sömmerda	 Erwin Fascher Managing Director