

22 Converter Sockets DIL → SOP Reduction Sockets DIL → DIL Series 599

- ① Converter socket DIL → SOP solder on the PCB.
- ② Converter socket Skinny DIL → DIL
No capillary action during soldering due to screened inner contact. No fluxing medium or tin in the contact area.

Contact clip Surface Beryllium copper
Nickel 2 - 3 µm, gold flash

Contact pin Surface typical CuZn alloy turned
nickel 2 - 3 µm,
tin 5 µm (Sn100)
or gold 0,15 µm

Insulator body Thermoplastic polyester
glass-fibre reinforced, self-
extinguishing rated UL94V0.

PCB Glas-fibre Epoxyd EP-GC 02,
self-extinguishing rated UL94V0,
(35 µm copper tin-plated Sn100
or chemical Ni/Au)

Operation temperature -55 up to +125 °C

Solder temperature
from 235°C acc. IEC 68-2-54 Ta

Solder head resistance
up to 260°C 10 sec. acc. IEC 68-2-20 Tb

Contact depth 2.4 mm by safe contact making

Accepted diameter 0.4 - 0.56 mm

Mechanical life > 50

Rated voltage 100 V_{RMS}/150 VDC

Contact resistance < 30 mΩ

Insulation resistance > 5 x 10⁹ Ω

Air and creepage distance PCB > 0.3 mm
Insulator body > 0.7 mm

Current carrying capacity per contact 1 A

Moisture sensibility level (MSL)

J-STD-020C Level 1

RoHS-conform

- ① The DIL → SOP Converter socket can be inserted or soldered as required.

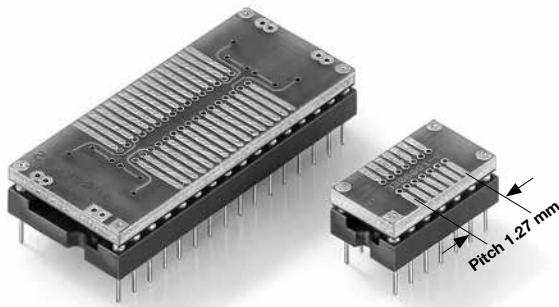

- ② Skinny DIL → DIL Converter sockets for electrically similar components with different widths and pitches.

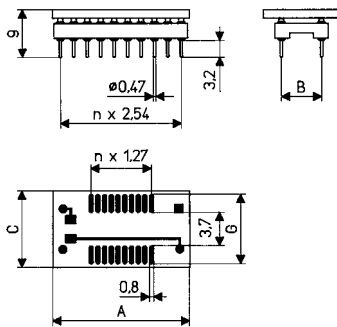
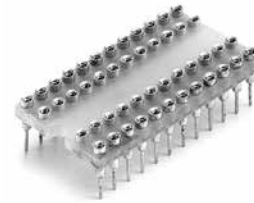

Series 599

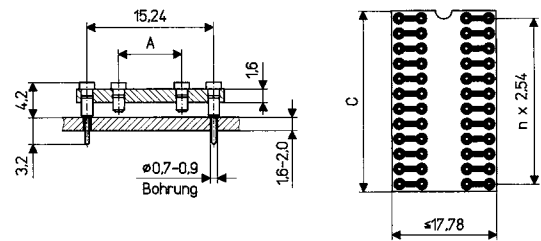

A	B	C	G	Pins	PU	Converter Socket	Part No.
10.2	7.62	10.2	9.8	8	52	SOP8-DIP308	3305702
17.8	7.62	10.2	9.8	14	29	SOP14-DIP314	3305704
20.4	7.62	10.2	9.8	16	25	SOP16-DIP316	3305706
20.4	7.62	14.0	13.2	16	25	SOP16W-DIP316	3305708
22.9	7.62	14.0	13.2	18	22	SOP18-DIP318	3305749
25.5	7.62	10.2	9.8	20	20	SOP20-DIP320	3305710
25.5	7.62	14.7	13.9	20	20	SOP20W-DIP320	3305712
30.5	7.62	17.8	16.8	24	17	SOP24-DIP324	3305750
30.5	15.24	17.8	16.8	24	17	SOP24-DIP624	3305714
35.6	7.62	17.8	16.8	28	14	SOP28-DIP328	3305752
35.6	15.24	17.8	16.8	28	14	SOP28-DIP628	3305716
40.7	15.24	17.8	16.8	32	12	SOP32-DIP632	3305718

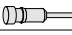
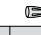
Surface		Sleeve → 		5 µm tin	
		Clip → 		Gold flash	
A	C	Pins	PU	Part No. New	Part No. Old
7.62	31.0	24	17	1005221	599-87-048-1501
7.62	36.2	28	14	1005860	599-87-056-1503
7.62	41.2	32	12	1004108	599-87-064-1505

W = Design „Wide“

PU = Packaging Unit