

## Completion to the Operator's Manual MACH4

### MACH4-24V

Part No. 9008617 Edition: 3/10

#### Product Description

MACH4-24V allows an operation independent from the mains voltage. The printer is designed for operation with a storage battery (22 - 30 VDC, 8 A).

The printer has nearly the same functionality like the standard MACH4 printers. Only the maximum print speed is limited to 100 mm/s.

#### Connection to Storage Battery



##### Attention!

**Operate the printer with storage battery only ! Do not use the printer with a power supply unit !**

The printer is equipped with a Neutrik® PowerCon® chassis plug. To connect the external storage battery a Neutrik® PowerCon® cable socket Type NAC3FCA is needed.

Assignment of the cable socket : L+ N-

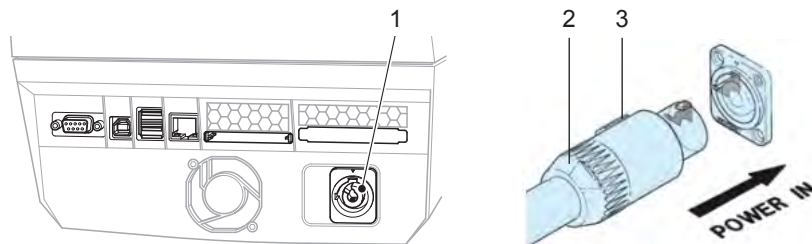

- ▶ Connect the cable socket (2) to the chassis plug (1) and turn the socket clockwise by 45 degree to fix it.



##### Notice!

The printer has no ON/OFF switch. The printer is immediately switched on after connecting the storage battery.



- ▶ To disconnect the battery pull back the clasp (3), turn the cable socket (2) counterclockwise by 45 degree and detach it from the plug (1).



##### Attention!

**Risk of damage ! Do not disconnect the battery during printing !**

#### Display of Battery Charge and Low Voltage Behavior

- On the display the additional widget  is available, which shows the battery charge state. Activation of widgets ▶ Configuration Manual.
- If the battery charge falls below approximately 30% the printer sends an acoustic signal every minute. The printer still can be operated.
- If the battery voltage falls below 21 V the printer shows  , sends an acoustic signal at frequent intervals and switches into a powersave mode. In that mode the printer cannot be operated.
- If the voltage falls below 20 V, the printer will be switched off automatically to avoid a total discharge of the battery.

#### Germany

cab Produkttechnik  
GmbH & Co KG

Postfach 1904  
D-76007 Karlsruhe  
Wilhelm-Schickard-Str. 14  
D-76131 Karlsruhe

Telefon +49 721 6626-0  
Telefax +49 721 6626-249  
www.cab.de  
info@cab.de

#### France

cab technologies s.a.r.l.  
F-67350 Niedermodern  
Téléphone +33 388 722 501

www.cab.de  
info@cab-technologies.fr

#### España

cab España S.L.  
E-08304 Montaró (Barcelona)  
Teléfono +34 937 414 605

www.cab.de  
info@cabsi.com

#### USA

cab Technology Inc.  
Tyngsboro MA, 01879  
Phone +1 978 649 0293

www.cabtechn.com  
info@cabtechn.com

#### South Afrika

cab Technology (Pty.) Ltd.  
2125 Randburg  
Phone +27 11-886-3580

www.cab.de  
info@cabtechn.co.za

#### Asia 亞洲分公司

希愛比科技股份有限公司  
cab Technology Co, Ltd.  
台灣台北縣中和市中正路 700 號 9F-8  
Junghe 23552, Taipei, Taiwan  
電話 Phone +886 2 8227 3966  
網址 www.cabasia.net  
詢問 cabasia@cab.de

#### China 中国

锐博(上海)贸易有限公司  
cab (Shanghai) Trading Co.,Ltd  
上海市延安西路2299号11C60室  
电话 Phone +86 21 6236-3161  
询问 cabasia@cab.de

Representatives in other countries on request.