

Assembly Instructions

Spacers (Part No. 6010586 / 6010590)

Edition: 06/2021 · Part No. 9003699

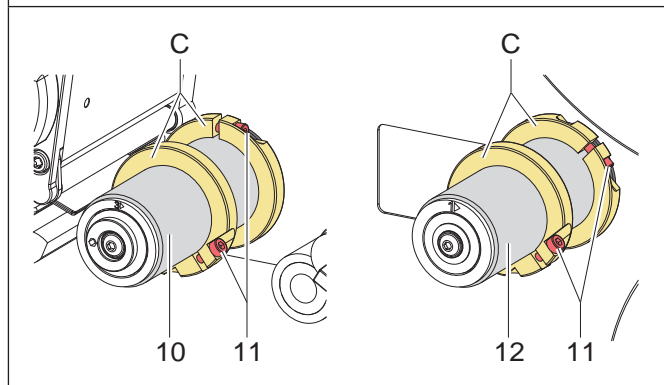
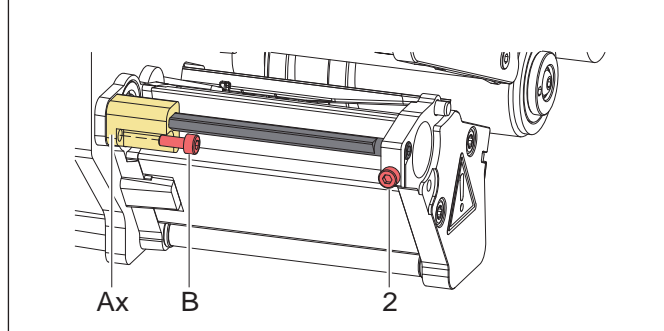
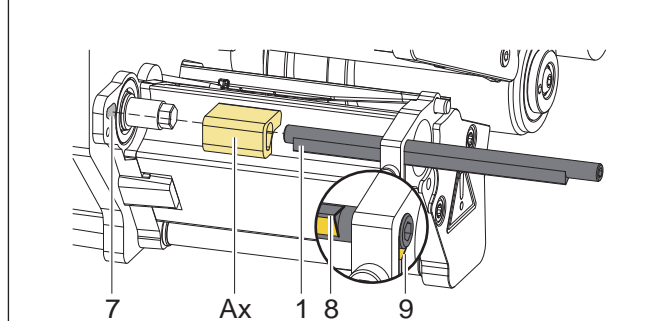
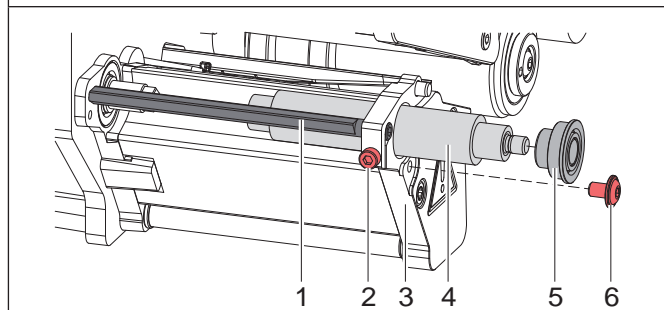
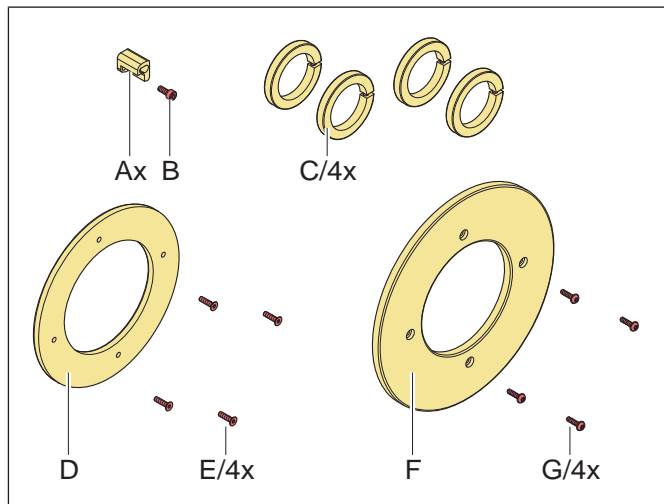

Contents of Delivery

Part No.	Description	Quantity
6010586	Spacers for HERMES QL	
6010590	Spacers for HERMES QR	
Al	- 6010583 Paper Guide (at 6010586)	1
Ar	- 6010584 Paper Guide (at 6010590)	1
B	- 5902005 Screw DIN912-M3x8	1
C	- 6010582 Ring	4
D	- 6010580 Distance Washer	1
E	- 5902030 Screw DIN7991-M3x12	4
F	- 6010585 Distance Washer	1
G	- 5902414 Screw EJOT-PT-K30x12	4

Intended Use

The Spacers are intended for the use in printers of the HERMES Q series.

With the spacers mounted the paper guidance will be displaced by 7 mm and ribbon can protruding on both sides to prevent ribbon wrinkling when processing narrow labels.

Mounting

Mounting the Paper Guide

- ▶ Loosen the screw (6) and push the print roller (4) with the bearing (5) out of the side plate (3).
- ▶ Loosen the screw (2) and push the peel-off edge (1) to the side plate (3) until the peel-off edge can be turned completely.
- ▶ Align the tip (8) of the peel-off edge with the cutout (9) in the side plate and push the peel-off edge through the side plate halfway.
- ▶ Put the paper guide (Ax) onto the peel-off edge and push the peel-off edge to the bearing point (7) in the chassis.
- ▶ Turn back the peel-off edge (1) to the starting position and fix the paper guide (Ax) with the screw (B).
- ▶ Tighten the screw (2).
- ▶ Mount the print roller (4) and the bearing (5) and fix them with the screw (6).

Mounting the Rings

- ▶ Put each two rings (C) onto the roller 1 and 3 (12,10).
- ▶ Push the inner rings to the stops of the rollers.
- ▶ Position the outer ring after loading label at the edge of the liner.
- ▶ Tighten the screws (11) at all rings.

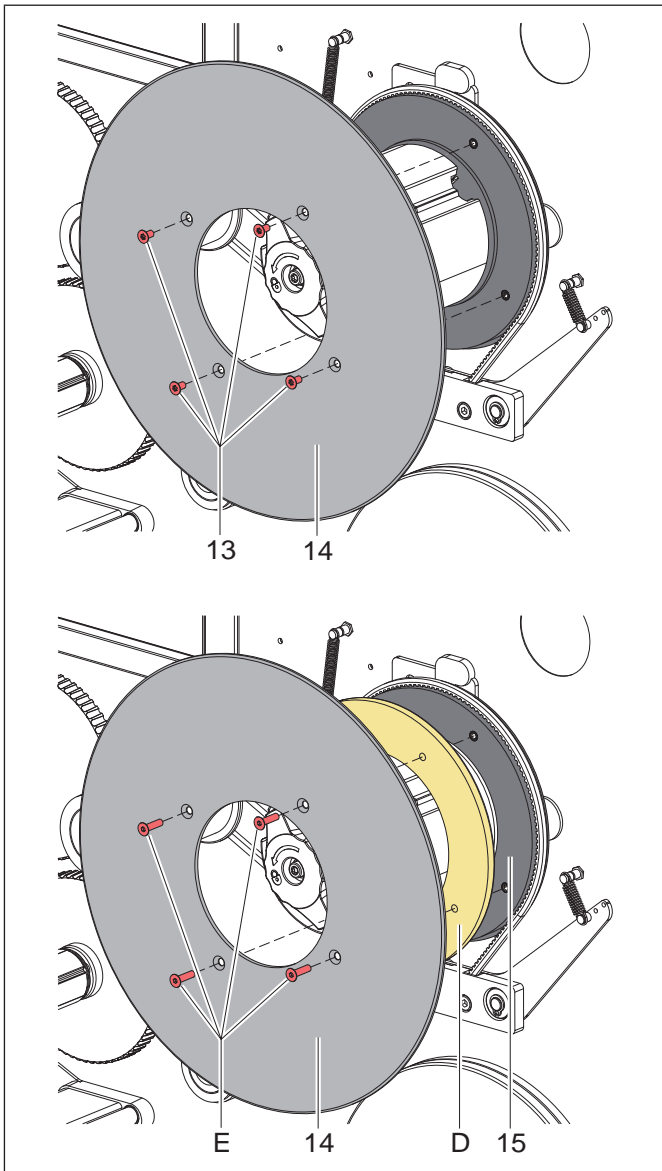

Mounting the Distance Washer at the Label Unwinder

- ▶ Loosen four screws (13) and remove the wall spacer (14) from the unwinder.
The screws (13) are no longer required.

- ▶ Put first the distance washer (D) and after the wall spacer (14) onto the unwinder.
- ▶ Align the holes in the wall spacer, the distance washer and the cone (15) with each other.
- ▶ Fix the wall spacer and the distance washer with four screws (E) at the cone (15).

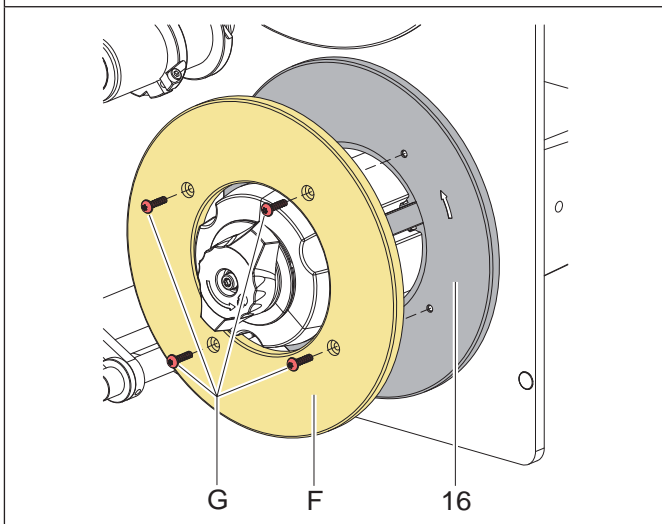

Mounting the Distance Washer at the Internal Rewinder

- ▶ Put the distance washer (F) onto the rewinder.
- ▶ Align the holes in the distance washer and the cone (16) with each other.
- ▶ Fix the distance washer with four screws (G) at the cone.

Germany
cab Produkttechnik GmbH & Co KG
 Karlsruhe
 Phone +49 721 6626 0
www.cab.de

USA
cab Technology, Inc.
 Chelmsford, MA
 Phone +1 978 250 8321
www.cab.de/us

Taiwan
cab Technology Co., Ltd.
 Taipei
 Phone +886 (02) 8227 3966
www.cab.de/tw

China
cab (Shanghai) Trading Co., Ltd.
 Guangzhou
 Phone +86 (020) 2831 7358
www.cab.de/cn

France
cab Technologies S.à.r.l.
 Niedermodern
 Phone +33 388 722501
www.cab.de/fr

Mexico
cab Technology, Inc.
 Juárez
 Phone +52 656 682 4301
www.cab.de/es

China
cab (Shanghai) Trading Co., Ltd.
 Shanghai
 Phone +86 (021) 6236 3161
www.cab.de/cn

South Africa
cab Technology (Pty) Ltd.
 Randburg
 Phone +27 11 886 3580
www.cab.de/za