

Assembly Instructions



Present Sensor

PS11

Made in Germany

Edition: 03/2016 - **Art.-No.** 9009836

Copyright

This documentation as well as translation hereof are property of cab Produkttechnik GmbH & Co. KG.

The replication, conversion, duplication or divulgement of the whole manual or parts of it for other intentions than its original intended purpose demand the previous written authorization by cab.

Editor

Regarding questions or comments please contact cab Produkttechnik GmbH & Co. KG.

Topicality

Due to the constant further development of our products discrepancies between documentation and product can occur.

Please check www.cab.de for the latest update.

Terms and conditions

Deliveries and performances are effected under the General conditions of sale of cab.

Germany

cab Produkttechnik
GmbH & Co KG
Postfach 1904
D-76007 Karlsruhe
Wilhelm-Schickard-Str. 14
D-76131 Karlsruhe

Telefon +49 721 6626-0
Telefax +49 721 6626-249

www.cab.de
info@cab.de

France

cab technologies s.a.r.l.
F-67350 Niedermodern
Téléphone +33 388 722 501

www.cab.de/fr
info.fr@cab.de

USA

cab Technology Inc.
Tyngsboro MA, 01879
Phone +1 978 649 0293

www.cab.de/us
info.us@cab.de

Asia 亚洲

cab Technology Co., Ltd.
希愛比科技股份有限公司
Junghe, Taipei, Taiwan
Phone +886 2 8227 3966

www.cab.de/tw
info.asia@cab.de

China 中国

cab (Shanghai)Trading Co., Ltd.
锐博(上海)贸易有限公司
Phone +86 21 6236-3161

www.cab.de/cn
info.cn@cab.de

1.1 Instructions

Important information and instructions are designated as follows:



Attention!

Draws attention to potential risks of property damage or loss of quality.



Note!

Advices to make work routine easier or on important steps to be carried out.



Handling instructions



Reference to chapter, position, picture number or document.

Time Viewed in the display / monitor.

1.2 Intended Use

- This device is an exclusive option for cab Hermes C printers to dispense labels approved by the manufacturer. Any other use or use going beyond this shall be regarded as improper use. The manufacturer/supplier shall not be liable for damage resulting from unauthorized use; the user shall bear the risk alone.
- Usage for the intended purpose also includes complying with the Assembly Instructions.



Note!

The complete documentation can also currently be found in the Internet.

The Present Sensor PS11 allows to operate the Hermes C in peel-off mode without applicator.

- In the Automatic mode a label will be printed and dispensed after sending a print job. After removing the label from the peel position the next label will immediately be transported to the peel position.
- In the Label on demand mode a label will only be printed and dispensed after pressing the key (2).

The existence of a label in the peel position will be checked by a reflective sensor (1).

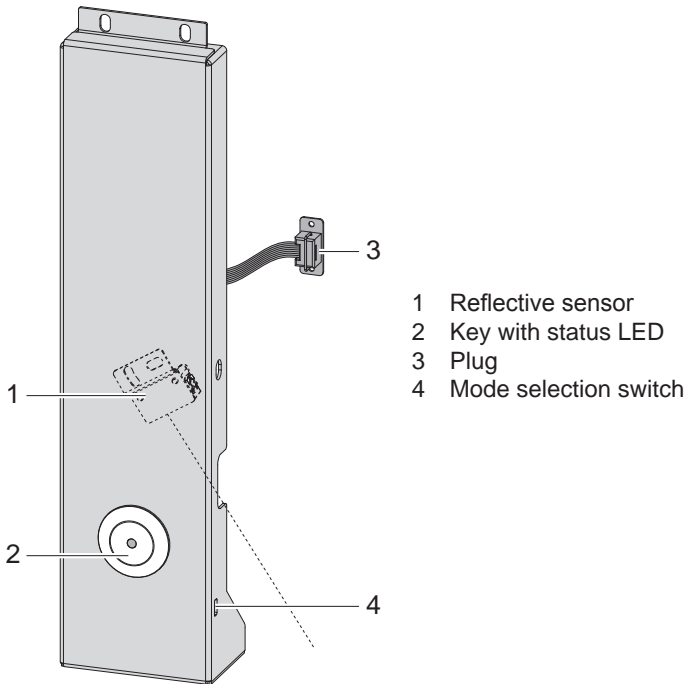

Figure 1 Present sensor PS11

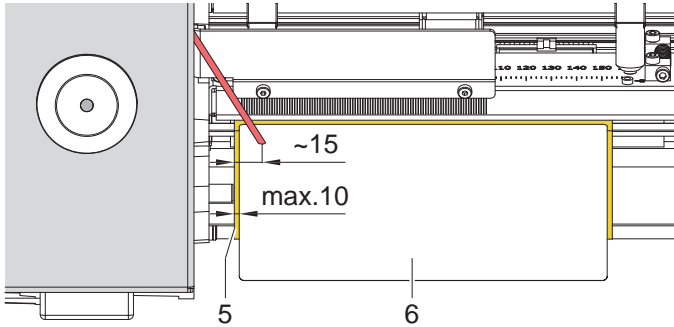

Figure 2 Label in peel position

The reflective sensor detects the label (6) about 15 mm from the left edge of the liner (5).



Attention!

To guarantee the function of the sensor, the distance between the label and the left edge of the liner may not exceed 10 mm.



Note!
Keep the original packaging for later transports.



Attention!

Damage and failure in function by dust, dirtiness and humidity.

► Use the device only in a clean and dry environment.

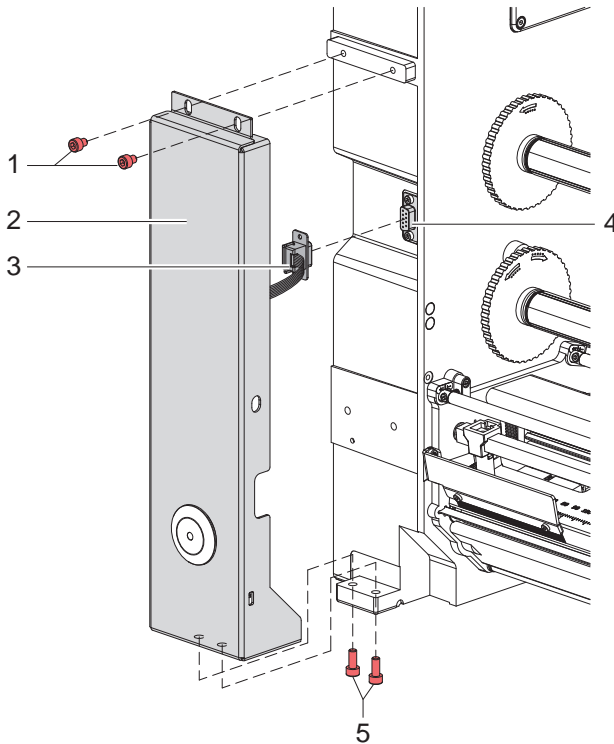

Figure 3 Mounting

1. Switch off the printer.
2. Connect the plug (3) to the peripheral port (4).
3. Fix the Present Sensor (2) with two screws M5x8 (1) and two screws M5x16 (5) on the printer.

4.1 General Settings

- ▶ Activate the peel-off mode in the software.
In direct programming use the "P" command.
 - ▷ Programming Manual of the printer.
- ▶ Configure the peel-off parameters.
 - ▷ 5 Printer Configuration

4.2 Setting the Operation Mode



Attention!

- ▶ Before setting the operation mode switch off the printer.

- ▶ Set the operation mode with the switch (1).

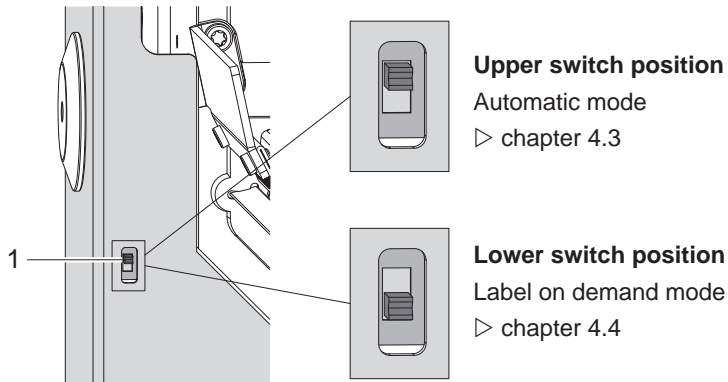

Figure 4 Setting the operation mode

4.3 Automatic Mode

- Switch is in upper position.
 - Key in the Present Sensor is disabled.
The LED on the key is permanently red.
1. Insert transfer ribbon and labels ▷ Operator's Manual Hermes C.
 2. Switch on the printer.
 3. Send a print job.
A label will be printed and transported the peel position. The reflective sensor in the PS11 detects the label and interrupts the transport until the label will be removed.
 4. Remove the label from the peel position.
The next label will be fed back to the printhead for the secondary color, printed and transported to the peel position.

4.4 Label on Demand Mode

- Switch is in lower position.
 - LED in the key is green when a label can be printed and peeled-off.
Otherwise the LED is red.
1. Insert transfer ribbon and labels ▷ Operator's Manual Hermes C.
 2. Switch on the printer.
 3. Send a print job.
 4. Press the key when the LED is green.
The LED changes to red. A label will be printed and transported the peel position. The reflective sensor in the PS11 detects the label and interrupts the transport until the label will be removed.
 5. Remove the label from the peel position.
The next label will be fed back to the printhead for the secondary color.
When the LED changes to green the system is ready for the next cycle.

**Note!**

The peel-off parameters can only be set with the Present Sensor PS11 installed.

**Note!**

For more information about the configuration procedure ▷ **Configuration Manual of the printer.**

- ▶ Press the **menu** key.
- ▶ Select Setup > Machine param. > Demand sensor



Parameter	Meaning	Default
 Demand sensor	Configuration of the peel-off parameters	
 > Peel position	Shift the position of the dispensed label relative to the dispensing edge. The Peel position can also be set via software. The offset values from the Machine param. menu and the software are added together.	0.0 mm
 > Backfeed delay	Delay time between removing the label from the peel position and the backfeed of the label.	250 ms

Table 1 Parameters of the menu Setup > Machine param. > Demand sensor.

The Present Sensor PS11 complies with the relevant fundamental regulations of the EU Rules for Safety and Health:

- Directive 2014/30/EU relating to electromagnetic compatibility
- Directive 2011/65/EU on the restriction of the use of certain hazardous substances in electrical and electronic equipment

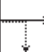
EU Declaration of Conformity

▷ <https://www.cab.de/media/pushfile.cfm?file=2725> 

