



**Vacuum-Belt
Applicator**

5314 / 5316

Made in Germany

2 Operator's Manual for the following products

2

Family	Type
Vacuum-Belt Applicator	5314 L-3
	5314 R-3
	5316 L-3
	5316 R-3

Edition: 03/2016 - Part.-No. 9009608

Copyright

This documentation as well as translation hereof are property of cab Produkttechnik GmbH & Co. KG.

The replication, conversion, duplication or divulgement of the whole manual or parts of it for other intentions than its original intended purpose demand the previous written authorization by cab.

Editor

Regarding questions or comments please contact cab Produkttechnik GmbH & Co. KG.

Topicality

Due to the constant further development of our products discrepancies between documentation and product can occur.

Please check www.cab.de for the latest update.

Terms and conditions

Deliveries and performances are effected under the General conditions of sale of cab.

Germany

cab Produkttechnik
GmbH & Co KG
Postfach 1904
D-76007 Karlsruhe
Wilhelm-Schickard-Str. 14
D-76131 Karlsruhe
Telefon +49 721 6626-0
Telefax +49 721 6626-249
www.cab.de
info@cab.de

France

cab technologies s.a.r.l.
F-67350 Niedermodern
Téléphone +33 388 722 501
www.cab.de/fr
info.fr@cab.de

USA

cab Technology Inc.
Tyngsboro MA, 01879
Phone +1 978 649 0293
www.cab.de/us
info.us@cab.de

Asia 亚洲

cab Technology Co., Ltd.
希愛比科技股份有限公司
Junghe, Taipei, Taiwan
Phone +886 2 8227 3966
www.cab.de/tw
info.asia@cab.de

China 中国

cab (Shanghai) Trading Co., Ltd.
乾博(上海)贸易有限公司
Phone +86 21 6236-3161
www.cab.de/cn
info.cn@cab.de

Representatives in other countries on request

1	Introduction	4
1.1	Instructions	4
1.2	Intended Use	4
1.3	Safety Instruction	4
1.4	Safety Marking	5
1.5	Environment	5
2	Product Description	6
2.1	Important Features	6
2.2	Technical Data	6
2.3	Overview	7
2.4	Contents of Delivery	8
3	Operation	9
3.1	Standard Operation	9
3.2	Cleaning	9
3	Mounting	10
4	Error Messages	11
4.1	Error messages of the printer	11
5.2	Error messages of the applicator	11
5	Licences	12
5.1	Declaration of Incorporation	12
5.2	EU Declaration of Conformity	13

1.1 Instructions

Important information and instructions in this documentation are designated as follows:



Danger!

Draws your attention to an exceptionally grave, impending danger to your health or life.



Warning!

Indicates a hazardous situation that could lead to injuries or material damage.



Attention!

Draws attention to possible dangers, material damage or loss of quality.



Notice!

Gives you tips. They make a working sequence easier or draw attention to important working processes.



Environment!

Gives you tips on protecting the environment.



Handling instruction



Reference to section, position, illustration number or document.



Option (accessories, peripheral equipment, special fittings).

Time Information in the display.

1.2 Intended Use

- The device is manufactured in accordance with the current technological status and the recognized safety rules. However, danger to the life and limb of the user or third parties and/or damage to the device and other tangible assets can arise during use.
- The device may only be used for its intended purpose and if it is in perfect working order, and it must be used with regard to safety and dangers as stated in the operating manual.
- The device applicator mounted on a cab printer of the Hermes+ series is intended exclusively for applying suitable materials that have been approved by the manufacturer. Any other use or use going beyond this shall be regarded as improper use. The manufacturer/supplier shall not be liable for damage resulting from unauthorized use; the user shall bear the risk alone.
- Usage for the intended purpose also includes complying with the operating manual, including the manufacturer's maintenance recommendations and specifications.



Notice!

The complete documentation can currently be found in the Internet.

1.3 Safety Instruction



Attention!

Initiation, adjustments and changing of parts is only for qualified service personal only.

▷ Initiation/ Service Manual Applicators



Warning!

This is a class A product. In a domestic environment this product may cause radio interference in which case the user may be required to take adequate measures.

- Before mounting the delivered components disconnect the printer from the power supply and close the shutoff valve at the applicator.
- Only connect the device to other devices which have a protective low voltage.
- Switch off all affected devices (computer, printer, accessories) before connecting or disconnecting.
- In operation, moving parts are easily accessible.
This applies especially for the zone of belts and fans. During operation do not reach into that zone and keep long hair, loose clothes, and jewelry distant.

- The device may only be used in a dry environment, do not expose it to moisture (sprays of water, mists, etc.).
- Do not use the device in an explosive atmosphere.
- Do not use the device close to high-voltage power lines.
- Perform only those actions described in this operating manual.
Work going beyond this may only be performed by trained personnel or service technicians.
- Unauthorized interference with electronic modules or their software can cause malfunctions.
- Other unauthorized work on or modifications to the device can also endanger operational safety.
- Always have service work done in a qualified workshop, where the personnel have the technical knowledge and tools required to do the necessary work.
- There are various warning stickers on the device. They draw your attention to dangers. Warning stickers must therefore not be removed, as then you and other people cannot be aware of dangers and may be injured.

1.4 Safety Marking

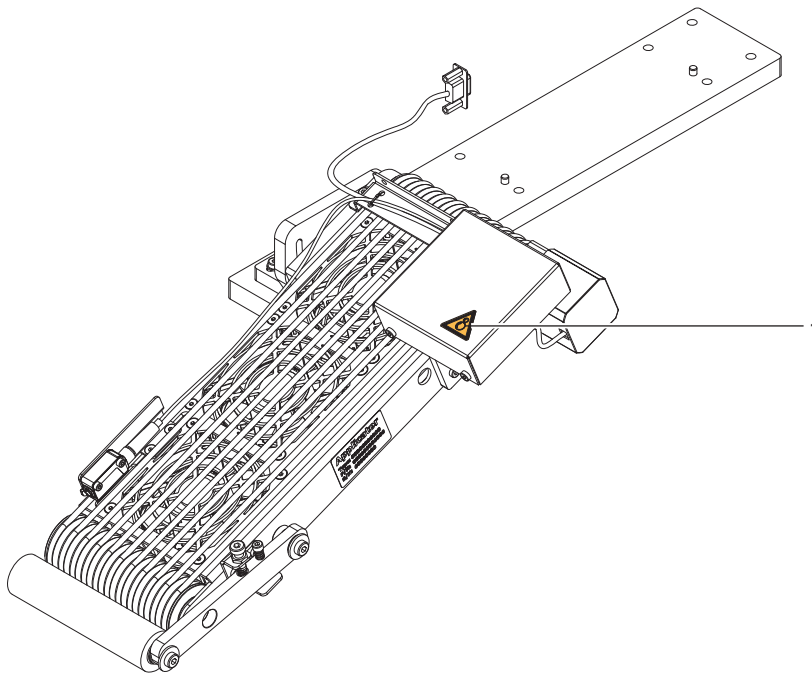

Fig. 1 Safety marking

1: Warning to damages by rotating parts !



Attention!
Never remove or cover safety markings!
Replace it in case of damage!

1.5 Environment



Obsolete devices contain valuable recyclable materials that should be sent for recycling.

- ▶ Send to suitable collection points, separately from residual waste.

The modular construction of the print module enables it to be easily disassembled into its component parts.

- ▶ Send the parts for recycling.

2.1 Important Features

- For operation in a system the I/O interface of the printer can be used.

2.2 Technical Data

Technische Daten		Saugband-Applikator 5314	Saugband-Applikator 5316
Etikettenbreite	Hermes+4 mm	20 – 114	–
	Hermes+6 mm	–	50 – 174
Etikettenhöhe	mm	70 – 320	
Produkt während der Etikettierung	in Bewegung	■	
Etikettierung auf das Produkt	von oben	■	
	von unten	■	
	von der Seite	■	
Produktabstand	fest	■	
Riementransportband Geschwindigkeit	mm/s	100 / 150 / 220 / 300	
Länge	mm	390	
Taktrate ca. ¹⁾	Etiketten/min.	30	

1) Ermittelt bei 100 mm Etikettenhöhe / Druckgeschwindigkeit 100 mm/s

Table 1 Technical Data

2.3 Overview

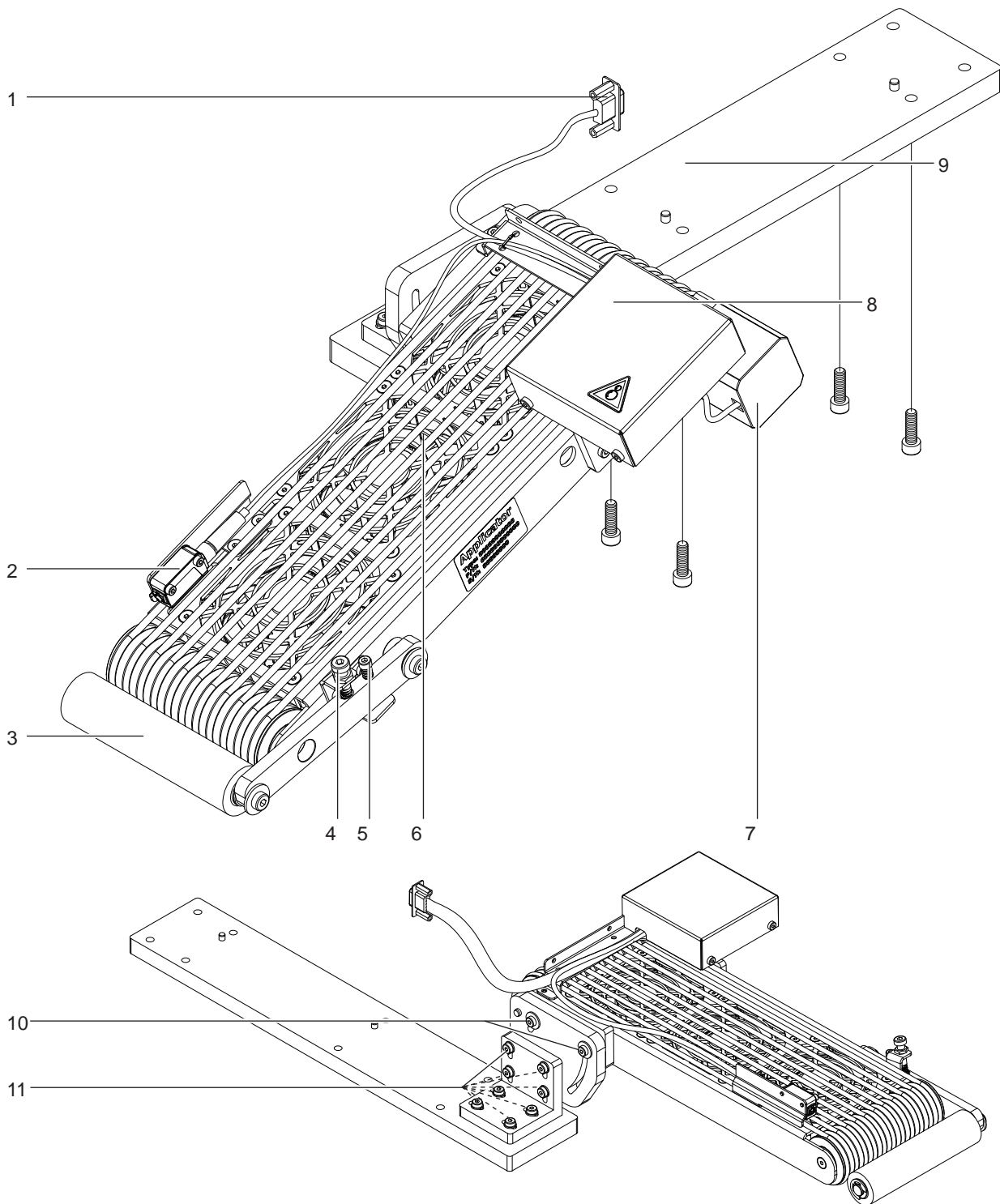

Fig. 2 Device overview

- | | |
|-------------------------------------|---|
| 1 SUB-D 15 Interface to the printer | 7 Motor belts |
| 2 Sensor | 8 Control unit |
| 3 Pressure roller | 9 Base plate for mounting on printer |
| 4 Setting screw roller pressure | 10 Screws to adjust the angle of the applicator |
| 5 Setting screw stopper roller | 11 Screws to adjust the applicator direction |
| 6 Fan | |

2.4 Contents of Delivery

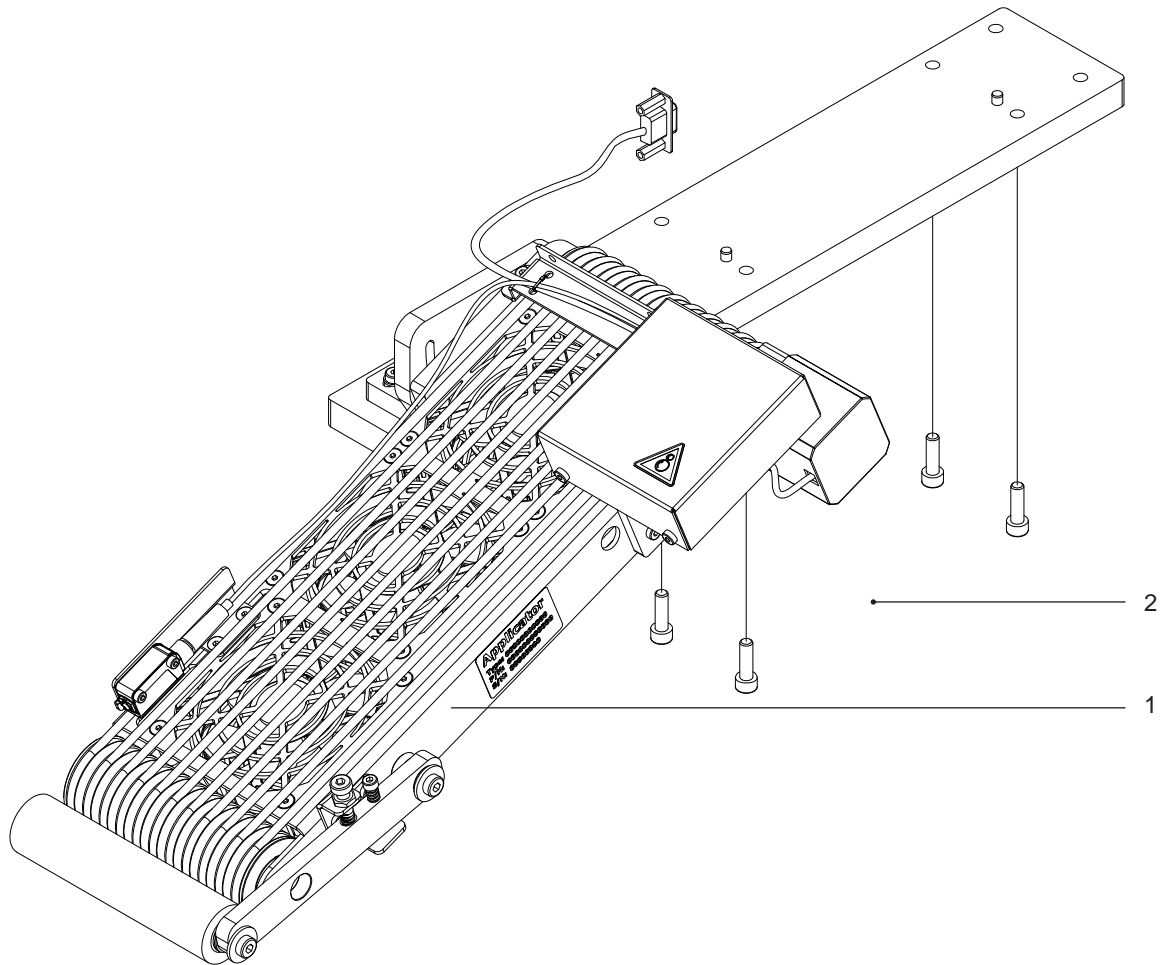

Fig. 3 Contents of delivery

- 1 Applicator mountet
- 2 Screws to mount on the printer
- 3 Documentation

**Notice!**

Please keep the original packaging in case the applicator must be returned.

**Attention!**

The device and printing materials will be damaged by moisture and wetness.

- ▶ Set up label printer with applicator only in dry locations protected from splash water.

3.1 Standard Operation

- ▶ Check all external connections.
- ▶ Load the material. Ensure that the locking system is locked ▷ "Operator's Manual" of the printer.
- ▶ Switch on the printer.
- ▶ Press the **feed** key at the printer.
A synchronization feed is released. The processed labels have to be removed manually. After a few seconds the printer carries out a short backfeed to position the front edge of the next label at the printing line.



Notice!

This synchronizing also has to be carried out when the print job has been interrupted with the cancel key. Synchronizing is not necessary when the print head was not lifted between print jobs. This also applies if the printer was powered off between print jobs.

- ▶ Start a print job
- ▶ Start the labelling process via PLC interface.

Error messages during labelling process are shown in the display of the printer ▷ Error Messages.

3.2 Cleaning



Attention!

Never use solvent and abrasive.

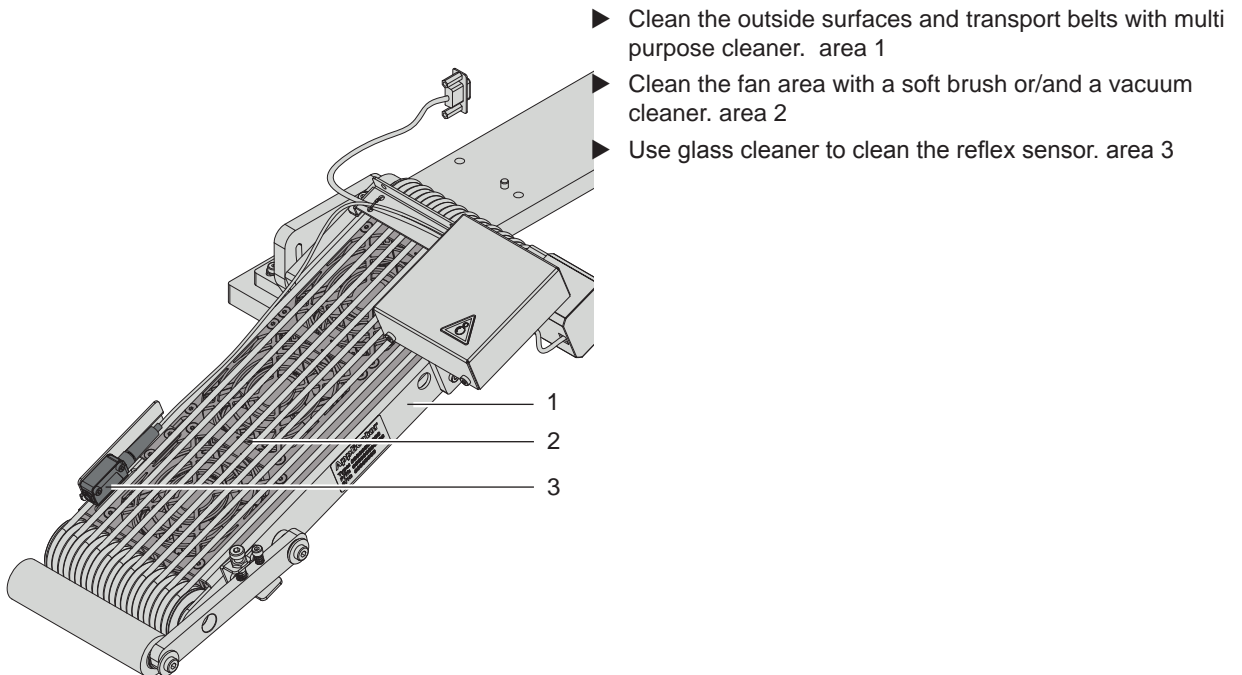

Fig. 4 Cleaning

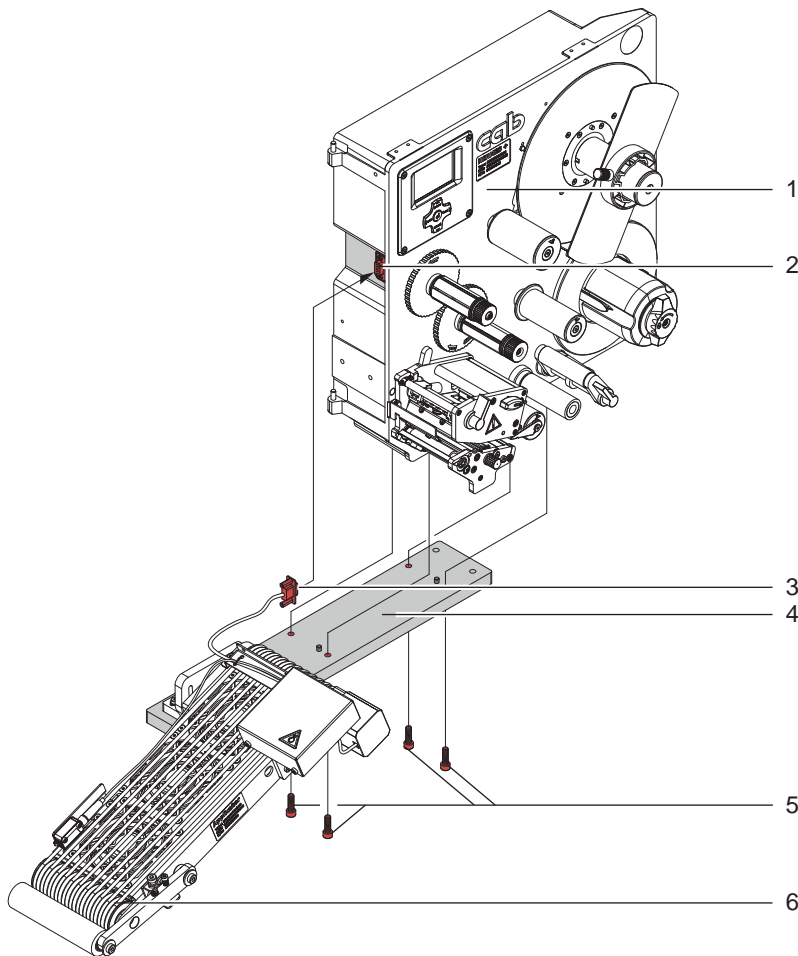

Fig. 5 Mounting applicator on printer

- 1 Put the printer on the backside - print head unit and material transport unit on top.
- 2 Hold the mounted applicator (6) on the printer so that the holes in the mounting plate (4) are direct over the holes in the bottom side of the printer chassis (1).
- 3 Put in screws (5) and tighten it.
- 4 Put in the Sub-D 9 male connector (3) into the Sub-D 9 female connector (2) of the printer.



Attention!

Initiation, adjustments and changing of parts is only for qualified service personal only.

▷ Initiation / Service Manual Applicators



Attention!

▶ Disconnect the printer from the power supply before mounting the applicator !

▶ Ensure a stable standing of the printer !

4 Error Messages

4.1 Error messages of the printer

For detailed information about printer errors (e.g. 'Paper out', 'Ribbon out', etc.) ▷ Operator's manual of the printer
Error treatment :

- ▶ Clear the error results
- ▶ Press the **feed** key to synchronize the label feed, remove the peeled labels manually
- ▶ Press the **pause** key to quit the error state.

After error correction, the print of the label causing the error will be repeated.

5.2 Error messages of the applicator

The following table contains an overview of error messages and their possible causes. It also suggests methods to resolve the problem :

Error Message	Possible Cause
Vac. plate empty	Label is removed of the waiting position on the pinch roller before the signal START was come in.
Upper position	The label had not arrived the sensor area 5 sec. after print or it wasn't detected.

Table 2 Error messages of the applicator

Error treatment :

- ▶ Clear the error results
- ▶ Press the **pause** key to quit the error state.



Notice!

In fault check adjustments and settings with help of the Service Manual.

After error correction, the print of the label causing the error cannot be repeated without re-start of the print job. Except at the error "Vac. plate empty" . In this case, the latest label will print again after quit the error with the **pause** key and then press the Enter button ↵.

- ▶ In the application mode "Apply/Print" send the signal "Print first label" or press the button ↵ to send a printed label to the applicator.

5.1 Declaration of Incorporation



Declaration of Incorporation

We declare herewith that the following „partly completed machinery“ as a result of design, construction and the version put in circulation complies with the essential requirements of the **Directive 2006/42/EC on machinery** :

Annex I, Article 1.1.2, 1.1.3, 1.1.5, 1.1.6, 1.2.1, 1.3.2, 1.5.2, 1.5.8, 1.6.3, 1.7

In the event of any alteration which has not been approved by us being made to any device as designated below, this statement shall thereby be made invalid.

Device:	Vacuum-Belt Applicator
Type:	5314 / 5316
Applied EU Regulations:	Applied Standards:
Directive 2006/42/EC on machinery	<ul style="list-style-type: none"> • EN ISO 12100:2010 • EN ISO 13849-1:2008 • EN 60950-1:2006 +A11:2009+A12:2011+A1:2010+A2:2013
Other Relevant Directives:	
<ul style="list-style-type: none"> • Directive 2014/30/EU relating to electromagnetic compatibility • Directive 2011/65/EU on the restriction of the use of certain hazardous substances in electrical and electronic equipment 	
Person authorised to compile the technical file :	Erwin Fascher Am Unterwege 18/20 99610 Sömmerda
Signed for, and on behalf of the Manufacturer :	Sömmerda, 01.03.2016
cab Produkttechnik Sömmerda Gesellschaft für Computer- und Automationsbausteine mbH 99610 Sömmerda	 Erwin Fascher Managing Director

The product must not be put into service until the final machinery into which it is to be incorporated has been declared in conformity with the provisions of the Directive on machinery

The documents according annex VII part B from the incomplete machinery are created and will commit to state agencies on request in electronic kinds.

5.2 EU Declaration of Conformity

**EU Declaration of Conformity**

We declare herewith that the following device as a result of design, construction and the version put in circulation complies with the relevant fundamental regulations of the EU Rules for Safety and Health. In the event of any alteration which has not been approved by us being made to any device as designated below, this statement shall thereby be made invalid.

Device:	Vacuum-Belt Applicator
Type:	5314 / 5316
Applied EU Regulations:	Applied Standards:
Directive 2014/30/EU relating to electromagnetic compatibility	<ul style="list-style-type: none"> • EN 55022:2010 • EN 55024:2010 • EN 61000-6-2:2005
Directive 2011/65/EU on the restriction of the use of certain hazardous substances in electrical and electronic equipment	<ul style="list-style-type: none"> • EN 50581:2012
Signed for, and on behalf of the Manufacturer :	Sömmerda, 01.03.2016
cab Produkttechnik Sömmerda Gesellschaft für Computer- und Automationsbausteine mbH 99610 Sömmerda	 Erwin Fascher Managing Director