

## Mounting Instructions

### Bracket Hermes+

Edition: 6/11 · Part No. 9009208

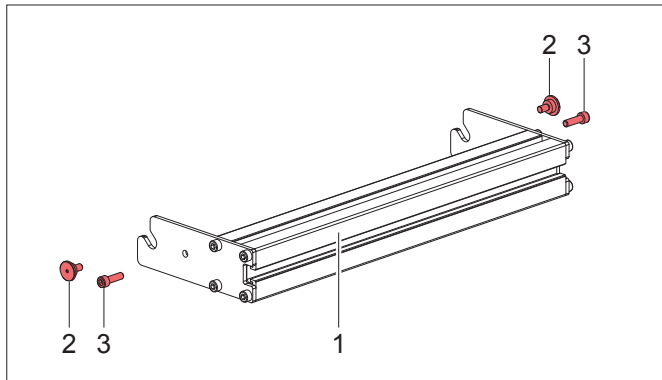

The bracket is a mounting element, which allows to hang in the a Hermes+ printer in to a production line.

### Contents of Delivery

- 1 - Bracket (profile 50x50, Rose+Krieger)
- 2 - 2 Center Screws
- 3 - 2 Screws M6x14

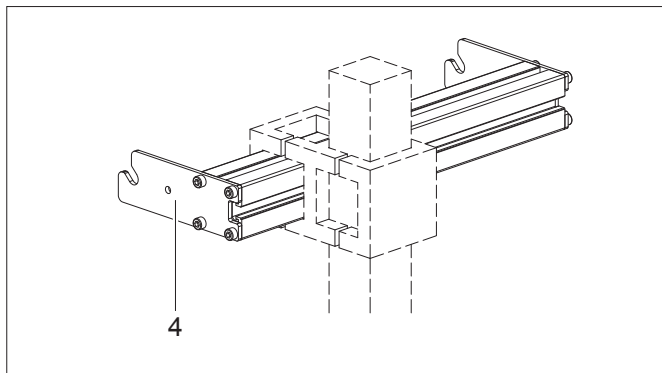

### Mounting

- ▶ Mount the bracket to the production line.  
If necessary remove meanwhile the side plates (4).

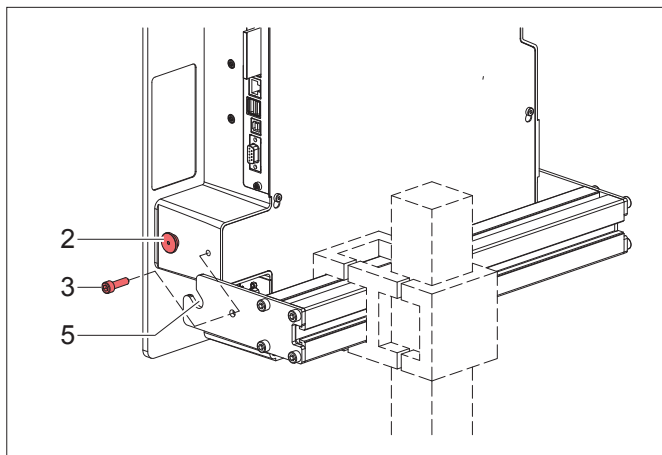

- ▶ Attach the center screws (2) on both sides of the frame.
- ▶ Hang in the printer into the bracket by inserting the center screws (2) into the grooves (5) of the bracket.
- ▶ Fix the printer at both sides with each one screw M6x14 (3).

#### Germany

cab Produkttechnik  
GmbH & Co KG  
Postfach 1904  
D-76007 Karlsruhe  
Wilhelm-Schickard-Str. 14  
D-76131 Karlsruhe  
Telefon +49 721 6626-0  
Telefax +49 721 6626-249  
www.cab.de  
info@cab.de

#### France

cab technologies s.a.r.l.  
F-67350 Niedermodern  
Téléphone +33 388 722 501  
www.cab.de  
info@cab-technologies.fr

#### España

cab España S.L.  
E-08304 Montaró (Barcelona)  
Teléfono +34 937 414 605  
www.cab.de  
info@cabsl.com

#### USA

cab Technology Inc.  
Tyngsboro MA, 01879  
Phone +1 978 649 0293  
www.cabtechn.com  
info@cabtechn.com

#### South Afrika

cab Technology (Pty.) Ltd.  
2125 Randburg  
Phone +27 11-886-3580  
www.cab.de  
info@cabtechn.co.za

#### Asia 亞洲分公司

希愛比科技股份有限公司  
cab Technology Co, Ltd.  
台灣台北縣中和市中正路 700 號 9F-8  
Junghe 23552, Taipei, Taiwan  
電話 Phone +886 2 8227 3966  
網址 www.cabasia.net  
詢問 cabasia@cab.de

#### China 中国

铠博(上海)贸易有限公司  
cab (Shanghai) Trading Co.,Ltd  
上海市延安西路 2299 号 11C60 室  
电话 Phone +86 21 6236-3161  
询问 cabasia@cab.de

Representatives in other countries on request.