



## Applicator 4314 / 4316 L/R

Family	Type
Applicator	4314L-200
	4314L-300
	4314L-400
	4314R-200
	4314R-300
	4314R-400
	4316L-200
	4316L-300
	4316L-400
	4316R-200
	4316R-300
	4316R-400

**Edition:** 10/2012 - Part.-No.: 9008081

### Copyright

This documentation as well as translation hereof are property of cab Produkttechnik GmbH & Co. KG.

The replication, conversion, duplication or divulgement of the whole manual or parts of it for other intentions than its original intended purpose demand the previous written authorization by cab.

### Editor

Regarding questions or comments please contact cab Produkttechnik GmbH & Co. KG.

### Topicality

Due to the constant further development of our products discrepancies between documentation and product can occur. Please check [www.cab.de](http://www.cab.de) for the latest update.

### Terms and conditions

Deliveries and performances are effected under the General conditions of sale of cab.

#### Germany

cab Produkttechnik  
GmbH & Co KG  
Postfach 1904  
D-76007 Karlsruhe  
Wilhelm-Schickard-Str. 14  
D-76131 Karlsruhe  
Telefon +49 721 6626-0  
Telefax +49 721 6626-249  
[www.cab.de](http://www.cab.de)  
[info@cab.de](mailto:info@cab.de)

#### France

cab technologies s.a.r.l.  
F-67350 Niedermodern  
Téléphone +33 388 722 501  
[www.cab.de/fr](http://www.cab.de/fr)  
[info.fr@cab.de](mailto:info.fr@cab.de)

#### USA

cab Technology Inc.  
Tyngsboro MA, 01879  
Phone +1 978 649 0293  
[www.cab.de/us](http://www.cab.de/us)  
[info.us@cab.de](mailto:info.us@cab.de)

#### South Africa

cab Technology (Pty.) Ltd.  
2125 Randburg  
Phone +27 11-886-3580  
[www.cab.de/za](http://www.cab.de/za)  
[info.za@cab.de](mailto:info.za@cab.de)

#### Asia 亚洲

cab Technology Co., Ltd.  
希愛比科技股份有限公司  
Junghe, Taipei, Taiwan  
Phone +886 2 8227 3966  
[www.cab.de/tw](http://www.cab.de/tw)  
[info.asia@cab.de](mailto:info.asia@cab.de)

#### China 中国

cab (Shanghai) Trading Co., Ltd.  
鉅博(上海)貿易有限公司  
Phone +86 21 6236-3161  
[www.cab.de/cn](http://www.cab.de/cn)  
[info.cn@cab.de](mailto:info.cn@cab.de)

Representatives in other countries on request

<b>1</b>	<b>Introduction .....</b>	<b>4</b>
1.1	Instructions.....	4
1.2	Intended Use.....	4
1.3	Safety Instruction .....	4
1.4	Safety Marking .....	5
1.5	Environment.....	5
<b>2</b>	<b>Product Description.....</b>	<b>6</b>
2.1	Important Features.....	6
2.2	Technical Data.....	6
2.3	Overview .....	7
2.4	Contents of Delivery.....	8
<b>3</b>	<b>Operation .....</b>	<b>9</b>
3.1	Standard Operation.....	9
3.2	Cleaning .....	9
<b>4</b>	<b>Error Messages .....</b>	<b>11</b>
4.1	Error Messages of the Printer .....	11
4.2	Error messages of the applicator .....	11
<b>5</b>	<b>Licences.....</b>	<b>12</b>
5.1	EC Declaration of Incorporation .....	12
5.2	EC Declaration of Conformity.....	13

## 1.1 Instructions

Important information and instructions in this documentation are designated as follows:



### **Danger!**

**Draws your attention to an exceptionally grave, impending danger to your health or life.**



### **Warning!**

**Indicates a hazardous situation that could lead to injuries or material damage.**



### **Attention!**

**Draws attention to possible dangers, material damage or loss of quality.**



### **Notice!**

**Gives you tips. They make a working sequence easier or draw attention to important working processes.**



### **Environment!**

**Gives you tips on protecting the environment.**



Handling instruction



Reference to section, position, illustration number or document.



Option (accessories, peripheral equipment, special fittings).

Time Information in the display.

## 1.2 Intended Use

- The device is manufactured in accordance with the current technological status and the recognized safety rules. However, danger to the life and limb of the user or third parties and/or damage to the device and other tangible assets can arise during use.
- The device may only be used for its intended purpose and if it is in perfect working order, and it must be used with regard to safety and dangers as stated in the operating manual.
- The device applicator mounted on a cab printer of the Hermes+ series is intended exclusively for applying suitable materials that have been approved by the manufacturer. Any other use or use going beyond this shall be regarded as improper use. The manufacturer/supplier shall not be liable for damage resulting from unauthorized use; the user shall bear the risk alone.
- Usage for the intended purpose also includes complying with the operating manual, including the manufacturer's maintenance recommendations and specifications.



### **Notice!**

**The complete documentation can currently be found in the Internet.**

## 1.3 Safety Instruction



### **Attention!**

**Initiation, adjustments and changing of parts is only for qualified service personal only.**

▷ **Initiation/ Service Manual Applicators**

- Before mounting the delivered components disconnect the printer from the power supply and close the shutoff valve at the applicator.
- Only connect the device to other devices which have a protective low voltage.
- Switch off all affected devices (computer, printer, accessories) before connecting or disconnecting.
- In operation, moving parts are easily accessible.  
This applies especially for the zone, where the pad is moved between the starting and the labelling position. During operation do not reach into that zone and keep long hair, loose clothes, and jewelry distant. Before any manipulations in those areas, close the shutoff valve.
- The device may only be used in a dry environment, do not expose it to moisture (sprays of water, mists, etc.).

- Do not use the device in an explosive atmosphere.
- Do not use the device close to high-voltage power lines.
- Perform only those actions described in this operating manual.  
Work going beyond this may only be performed by trained personnel or service technicians.
- Unauthorized interference with electronic modules or their software can cause malfunctions.
- Other unauthorized work on or modifications to the device can also endanger operational safety.
- Always have service work done in a qualified workshop, where the personnel have the technical knowledge and tools required to do the necessary work.
- There are various warning stickers on the device. They draw your attention to dangers. Warning stickers must therefore not be removed, as then you and other people cannot be aware of dangers and may be injured.

## 1.4 Safety Marking

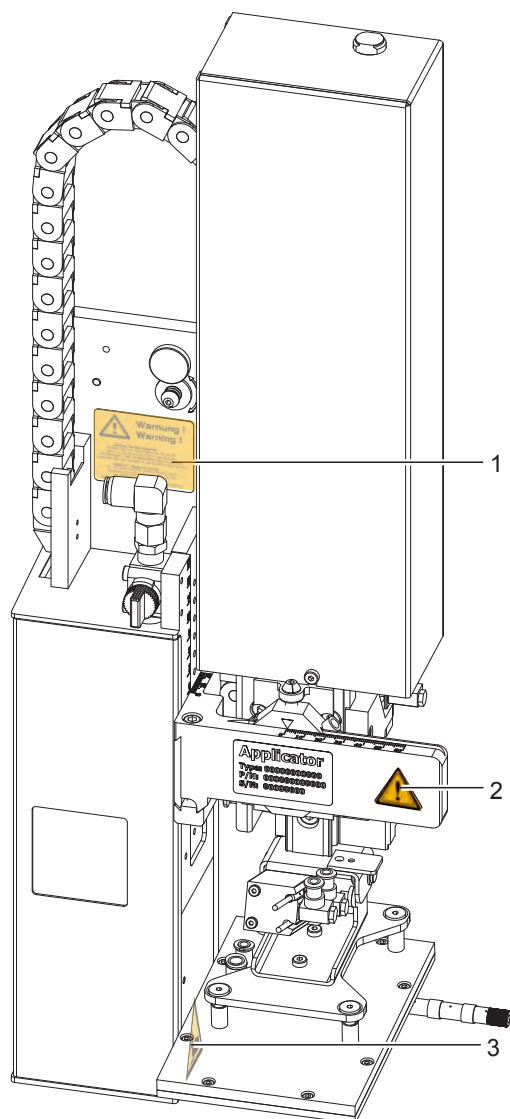

- 1:

Warnung!  
Warnung!

Achtung! Verletzungsgefahr!  
Greifen Sie beim Zueinanderdrücken des Querschnittes nicht an. Beachten Sie die bewegten Teile, insbesondere die Ausgelenke. Beachten Sie die Hinweise in der Bedienungsanleitung.

Achtung! Gefahr of crushing!  
Do not touch into the gap of moving parts, especially the gap when assembling or the gap of screw in during operation.  
Note the warnings given in the Operator's Manual.

Warning to damages by moving parts !
- 2:

Cylinder is under pressure,  
also is it switched off  
Possibility of remain energy!
- 3:

Danger of crushing to hand and  
fingers by the moving pad !

**Attention!**  
Never remove or cover safety markings!  
Replace it in case of damage!

Fig. 1 Safety marking

## 1.5 Environment



Obsolete devices contain valuable recyclable materials that should be sent for recycling.

- Send to suitable collection points, separately from residual waste.
- The modular construction of the print module enables it to be easily disassembled into its component parts.
- Send the parts for recycling.

## 2.1 Important Features

- The supporting air and the vacuum as well as the speed of the cylinder are adjustable. That way the applicator can be adapted to different label materials and sizes.
- To avoid contamination within the vacuum channels they are cleaned by air pressure impulse at the end of each application.
- For operation in a system the I/O interface of the printer can be used.

## 2.2 Technical Data

### Type 4314 / 4316

Label transfer method			Stamp on spring mounted
Label width in mm for Hermes <sup>+</sup> 4			100 - 114
for Hermes <sup>+</sup> 6			100 - 174
Label height in mm			100-250
Cylinder stroke in mm			200 - 400
Compressed air pressure			0,45 MPa (4,5 bar)
Sound pressure level			under 74 dB(A)
Product	fixed		■
	variable		-
Product height	fixed		-
	variable		■
Distance product to lower device edge			
with cylinder stroke	200 mm	till	130
	300 mm	till	230
	400 mm	till	330
Retraction depth of the stamp till in mm			70
Cycle time about pulse/min.			20

Table 1

Technical Data

### 2.3 Overview

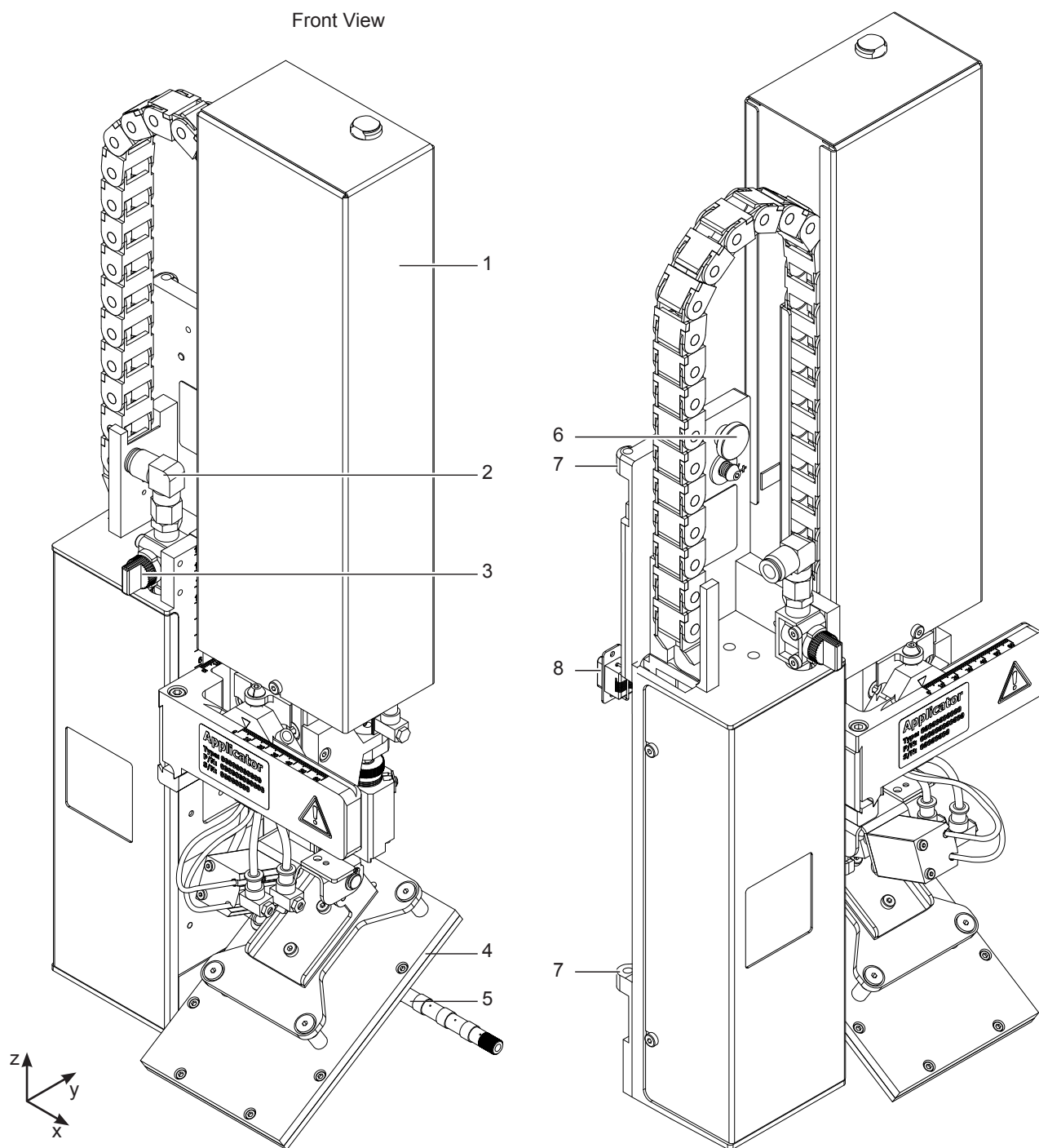
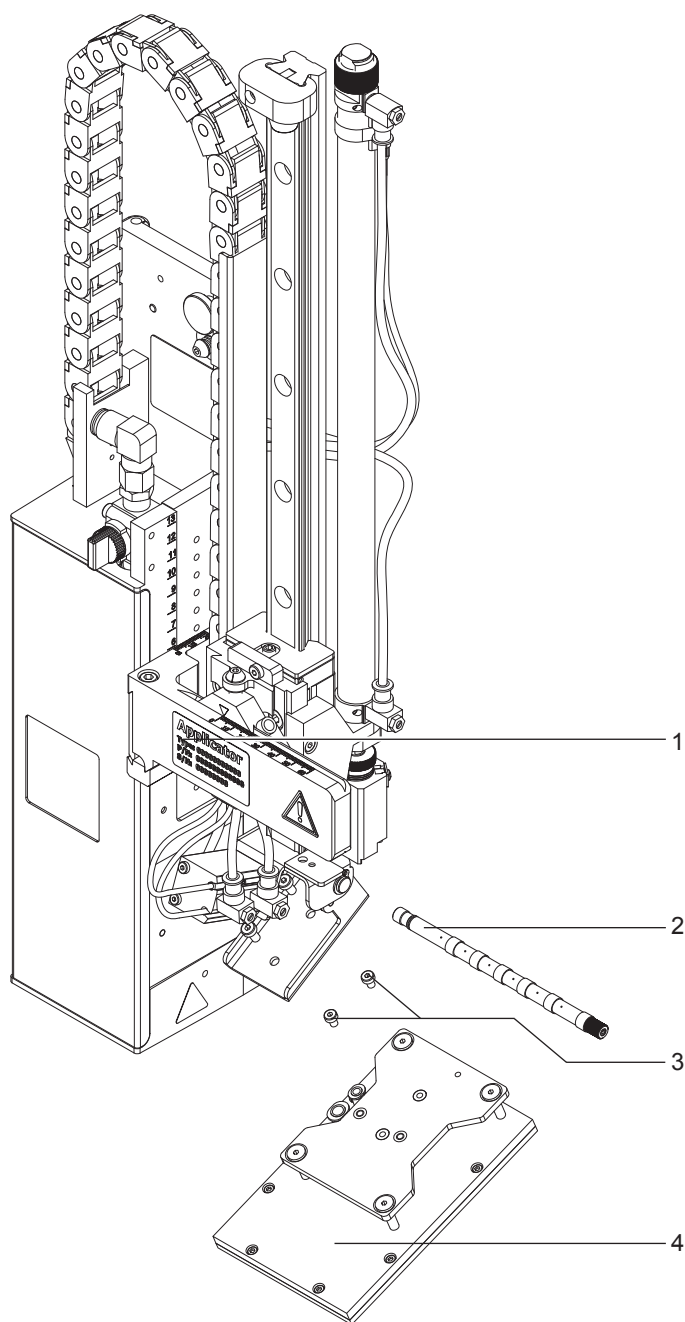

Fig. 2 Device overview - front view

## 2.4 Contents of Delivery



- 1 Applicator
- 2 Blow tube (as ordered)
- 3 Screws (part of the pad)
- 4 Pad (as ordered)
- 5 Documentation

Fig. 3 Contents of delivery



**Notice!**

Please keep the original packaging in case the applicator must be returned.



**Attention!**

The device and printing materials will be damaged by moisture and wetness.

► Set up label printer with applicator only in dry locations protected from splash water.



## 3.1 Standard Operation

- ▶ Check all external connections.
- ▶ Load the material. Ensure that the locking system is locked ▷ "Operator's Manual" of the printer.
- ▶ Open the shutoff valve.

**Attention!**

- ▶ Ensure that the pad is not covered by a label when switching on the printer-applicator system. Otherwise the vacuum sensor may be calibrated faultily.

- ▶ Switch on the printer.

**Notice!**

In case the pad is outside the start position in the moment of switching on it will interrupted the procedure and give notice an error message on the display of the printer.



If you push the button pause on the printer is receipt the error and the applicator will move into the start position.

The Applicator is ready for work.

- ▶ Press the **feed** key at the printer.  
A synchronization feed is released. The processed labels have to be removed manually. After a few seconds the printer carries out a short backfeed to position the front edge of the next label at the printing line.

**Notice!**

This synchronizing also has to be carried out when the print job has been interrupted with the cancel key. Synchronizing is not necessary when the print head was not lifted between print jobs. This also applies if the printer was powered off between print jobs.

- ▶ Start a print job
- ▶ Start the labelling process via PLC interface.

Error messages during labelling process are shown in the display of the printer ▷ 4 Error Messages.

## 3.2 Cleaning

**Attention!**

Never use solvent and abrasive.

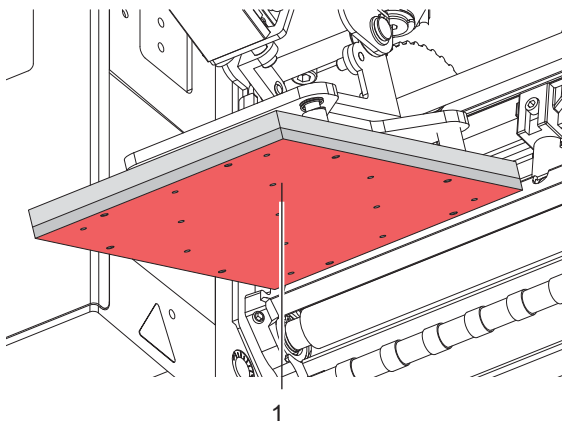

- ▶ Clean the outside surfaces with multi purpose cleaner.
- ▶ In regularly function it's possible that accrue dust particles and label splits. Remove that by a soft brush or/and a vacuum cleaner.
- ▶ Especially at slide foil (1) it's possible that fouling deposit. To receive an ideal takeover and handling of the label it's necessary to clean the surface of slide foil at regular intervals.

Fig. 4 Cleaning pad with slide foil

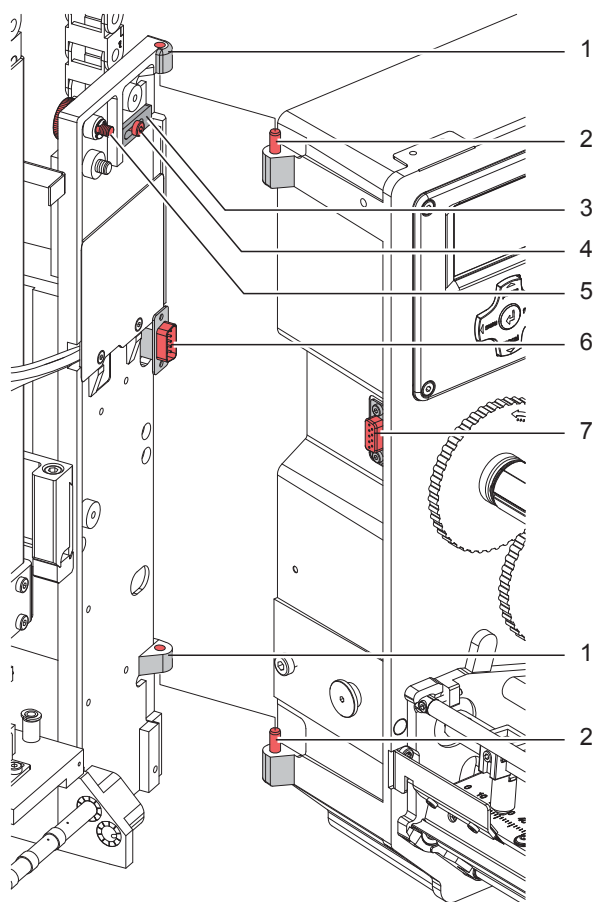

Fig. 5 Mounting applicator on printer



### Attention!

Initiation, adjustments and changing of parts is only for qualified service personal only.

▷ Initiation / Service Manual Applicators



### Attention!

- ▶ Disconnect the printer from the power supply before mounting the applicator !
- ▶ Ensure a stable standing of the printer !
- ▶ Connect the compressed air only after mounting the applicator to the printer !

for cleaning the applicator and printer it's sometime necessary to turn away or/and dismount the applicator. Don't change the adjustments of setting screws, throttle valves or other.

### Turn away / Dismount the applicator

1. To turn away the applicator loosen thumbscrew (5) and swing the applicator.
2. Disconnect SUB-D 15 male connector (6) to the female connector (7) of the printer.
3. Loosen screw (4) and move off the locking plate (3) from hinges.
4. Lift the applicator upward.

### Mount the applicator

5. Applicator hang with the female part (1) of hinges at the printer mounted hinges parts (2).
6. Connect SUB-D 15 male connector (6) to the female connector (7) of the printer.
7. To secure the applicator to slip out of hinges loosen screw (4) and move metal part (3) under the hinges and tighten screw (4).
8. Swing the applicator to the printer and tighten the thumbscrew (5).

### 4.1 Error Messages of the Printer

For detailed information about printer errors (e.g. 'Paper out', 'Ribbon out', etc.) ▷ Operator's manual of the printer  
Error treatment :

- ▶ Clear the error results
- ▶ Press the **feed** key to synchronize the label feed, remove the peeled labels manually
- ▶ Press the **pause** key to quit the error state.

After error correction, the print of the label causing the error will be repeated.

### 4.2 Error messages of the applicator

The following table contains an overview of error messages and their possible causes. It also suggests methods to resolve the problem :

Error Message	Possible Cause
Air pressure ins.	Compressed air is switched off
	Pressure too low < 4 bar
	Pressure too high > 6 bar
Label not depos.	Label has not been placed onto the product; after the pad has moved back the label still sticks on the pad.
Lower position	Pad is not in start position if the printer switched on.
	Pad has not reached the labelling position within 2s after the movement of the pad was started
	Pad has undefined leaving the start position.
Process Error	Process of labeling was braked via the I/O interface of the printer with the XSTP signal.
Refl. sensor blk.	There has been no change of the switch state at the upper sensor at the cylinder between the start of the labelling process and the signal from the labelling position sensor.
Vac. plate empty	Label has not been picked up properly by the pad; or label fell off the pad before it could be placed onto the product.
Upper position	Pad has not reached the starting position within 2s after the pad has left the labelling position; or pad has left the starting position unauthorized

Table 2 Error messages of the applicator

Error treatment :

- ▶ Clear the error results
- ▶ Press the **pause** key to quit the error state.

#### Notice!



In fault check adjustments and settings with help of the Service Manual.



#### Warning!

The pad will immediately be moved in the starting position !

Danger of crushing to hand and fingers by the moving pad !

- ▶ Do not reach into the zone of the moving pad and keep long hair, loose clothes, and jewelry distant.

After error correction, the print of the label causing the error cannot be repeated without re-start of the print job. Except at the error "Vac. plate empty" . In this case, the latest label will print again after quit the error with the **pause** key and then press the Enter button ↵.

- ▶ In the application mode "Apply/Print" send the signal "Print first label" or press the button ↵ to send a printed label to the tamp.

## 5.1 EC Declaration of Incorporation



Gesellschaft für Computer-  
und Automations-  
Bausteine mbH & Co KG  
Wilhelm-Schickard-Str. 14  
D-76131 Karlsruhe,  
Germany

## EC Declaration of Incorporation

We declare herewith that the following „partly completed machinery“ as a result of design, construction and the version put in circulation complies with the essential requirements of the **Directive 2006/42/EC on machinery** :

Annex I, Article 1.1.2, 1.1.3, 1.1.5, 1.1.6, 1.2.1, 1.3.2, 1.5.2, 1.5.8, 1.6.3, 1.7

The „partly completed machinery“ additionally complies with the Directive 2004/108/EC relating to electromagnetic compatibility.

In the event of any alteration which has not been approved by us being made to any device as designated below, this statement shall thereby be made invalid.

Device:	<b>Applicator</b>
Type:	<b>4314 / 4316</b>
Applied EC Regulations and Norms:	
<b>Directive 2006/42/EC on machinery</b>	<ul style="list-style-type: none"> <li>• EN ISO 12100:2010</li> <li>• EN 60950-1:2006+A11:2009</li> </ul>
Person authorised to compile the technical file :	<b>Erwin Fascher</b> <b>Am Unterwege 18/20</b> <b>99610 Sömmerda</b>
Signed for, and on behalf of the Manufacturer :	<b>Sömmerda, 05.01.2012</b>  <b>Erwin Fascher</b> <b>Managing Director</b>
<b>cab Produkttechnik Sömmerda</b> <b>Gesellschaft für Computer-</b> <b>und Automationsbausteine mbH</b> <b>99610 Sömmerda</b>	

The product must not be put into service until the final machinery into which it is to be incorporated has been declared in conformity with the provisions of the Directive on machinery

The documents according annex VII part B from the incomplete machinery are created and will commit to state agencies on request in electronic kinds.

Declaration of Conformity according Directive 2004/108/EC relating to electromagnetic compatibility on the next page

## 5.2 EC Declaration of Conformity



Gesellschaft für Computer-  
und Automations-  
Bausteine mbH & Co KG  
Wilhelm-Schickard-Str. 14  
D-76131 Karlsruhe,  
Germany

## EC Declaration of Conformity

We declare herewith that as a result of the manner in which the device designated below was designed, the type of construction and the devices which, as a result have been brought on to the general market comply with the relevant fundamental regulations of the EC Rules for Safety and Health. In the event of any alteration which has not been approved by us being made to any device as designated below, this statement shall thereby be made invalid.

Device:	<b>Applicator</b>
Type:	<b>4314 / 4316</b>
Applied EC Regulations and Norms:	Applied Norms:
<b>Directive 2004/108/EC relating to electromagnetic compatibility</b>	<ul style="list-style-type: none"> <li>• <b>EN 55022:2010</b></li> <li>• <b>EN 55024:2010</b></li> <li>• <b>EN 61000-6-2:2005</b></li> </ul>
Signed for, and on behalf of the Manufacturer :	<b>Sömmerda, 05.01.2012</b>  <b>Erwin Fascher</b> <b>Managing Director</b>
<b>cab Produkttechnik Sömmerda</b> <b>Gesellschaft für Computer-</b> <b>und Automationsbausteine mbH</b> <b>99610 Sömmerda</b>	